



## ROOMS & SUITES

The hotel offers 571 guests rooms including Standard, Superior, Business Class rooms, Suites, Presidential Suite and providing a choice of accommodation to suit any traveler's preference. Rooms in the hotel's tower section are of a light and modern design, and many boast enchanting views of the Old Town. The rooms in the North Wing are

finely decorated in a typically Scandinavian style featuring stunning landscapes on the walls.

Both smoking and non smoking rooms are available, and some rooms have allergy-friendly parquet floors. Every room is air-conditioned and features TV, direct phone line, mini bar, hire dryer and all necessary amenities to provide a great quality of comfort in a cosy

atmosphere. For those who want some extra luxury, we recommend our Business Class rooms and Suites. Other services such as Room Service, 3 hour Express Laundry and Express Check-out are also available.

Complimentary high speed wireless Internet is available throughout the hotel.

## FITNESS & RELAXATION

Relieve the stresses of a tiring but productive day in the brand new and conceptually unique ESPA Rīga spa center. ESPA Rīga offers an exclusive five star spa facility with luxurious interior design finishes, warm amber tones and the magnificent central feature of an architectural staircase embellished with a beautiful lighting sculpture. The sixth floor

spa has been uniquely tailored to provide a genuinely holistic and restorative experience for each guest.

ESPA Rīga offers a wide range of innovative and effective ESPA treatments with exceptionally natural skin care products.

Guests are welcome to experience 18-metre long swimming pool, vitality pool,

as well as saunas and steam room and variety of showers are on the 1st floor of Active Leisure Area. Before treatments guests can relax on the 6th floor Thermal Suite with saunas, steam rooms, relaxation areas and an open-air vitality pool. ESPA Rīga offers also Fitness studio, Manicure and Pedicure studios and healthy lunch at the Spa Café.

## RESTAURANT & BAR

4 individually designed restaurants and bars provide a variety of culinary delights and a natural place to relax and enjoy the company of friends and colleagues. Restaurant Esplanāde offers one of the best international cuisine buffets in Riga, alongside its à la carte menu.

Popular with the local business set in the daytime, the Lobby Bar's modern baroque look in red and gold is perfect for a rendezvous or for surfing the Internet with free WiFi. At D'vine, the hotel's wine bar guests can enjoy good wines, trendy Tapas

as well as delicious salads and main courses from the open kitchen. Located on the 26<sup>th</sup> floor the urban trendy Skyline Bar is the perfect place to enjoy the sunset, exotic cocktails, great bar food and smooth tunes with the best view in the city.

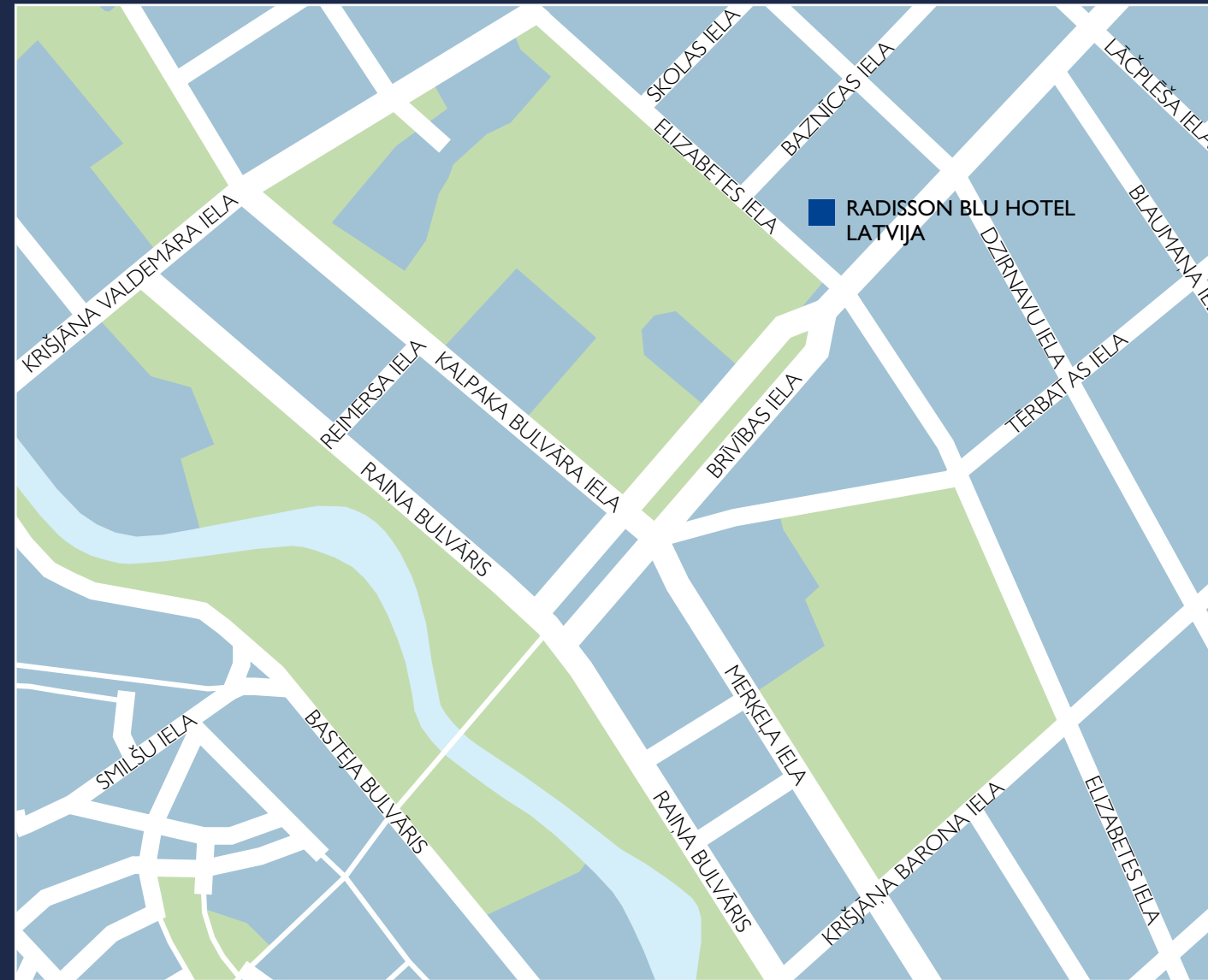

### BY COACH

Riga International Coach Terminal is only 10 minutes driving distance from the hotel.

### BY TRAIN

Riga is linked with direct railway services with Moscow and St Petersburg. Riga Train Station is located just 1.5 km from Radisson Blu Hotel Latvija.

### BY CAR

Centrally situated on the crossroads of Riga's main transport street Brīvības Street and Elizabetes Street hotels is easily accessible for the drivers.

### BY PLANE

Riga International Airport is just 15 km distance from the hotel. Currently airport offers more than 60 direct flights from Riga to Europe, Middle East, Central Asia and CIS countries making Riga a favorite travel hub between

### MEETING PLANNER

Radisson Blu Hotel Latvija, Riga, Latvia

## WELCOME TO RADISSON BLU



**Radisson Blu Hotel Latvija**  
55 Elizabetes Street, Riga, LV-1010, Latvia  
Tel.: +371 6709 3333, Fax: +371 6732 2600  
info.ridzene.riga@radissonblu.com  
[radissonblu.com/latvijahotel-riga](http://radissonblu.com/latvijahotel-riga)

**Radisson** **BLU**  
HOTEL LATVIJA, RIGA



## WELCOME

Welcome to Radisson Blu Hotel Latvija, a contemporary high-rise hotel with SPA in the city centre.

Offering the most impressive views over both the Old Town and central Riga, this hotel is famous for its lively atmosphere and wealth of entertainment options including restaurants, bars, casino, the trendy and stylish Skyline bar with its fabulous city view from 26<sup>th</sup> floor and the conceptually unique ESPA Riga spa facilities.

### Destination facts

Riga, the capital of Latvia, lies a few kilometers from the Gulf of Riga on the banks of the daugava River. One of the biggest cities of the Baltic region, it is also included in the UNESCO World Heritage List. Its architecture reflects the various periods of the city history since 1201, from the traditional wooden architecture of the city centre to one of the world's largest and best preserved collections of Art Nouveau buildings.

However, it is also a busy modern metropolis and an international centre for business and pleasure, boasting the biggest conference hotel in the Baltic region, the Radisson Blu Hotel Latvija. Nearly half the population of Latvia lives in Riga.

## MEETINGS & EVENTS

Situated on the second floor and covering over 2060 sq. m, the hotel features the region's largest and most modern Conference and Event Centre. The 15 fully adaptable and multifunctional meeting and event rooms offer the perfect environment for a successful and memorable meeting. Together with a fully equipped business centre, exhibition services

and a dedicated host, Conference and Event Centre provides, air-conditioning, high-speed Internet access, WiFi, AV equipment, simultaneous translation equipment, video-conferencing and the latest technical equipment you may require. The largest multifunctional conference room hosts up to 1100 delegates in theater style and it is a perfect venue to

organize your banquet dinner for up to 500 delegates. Most of the meeting rooms have a natural daylight, while the Sky Point room on hotel's 27<sup>th</sup> floor offers breathtaking panoramic views over the historical part of the city providing the memorable moments for the guests.

The one of the region's largest and most modern Conference and Event Centres offering 15 multifunctional rooms



- 1 Event
- 2 Lobby
- 3 Omega meeting room
- 4 Riga view from top floors of the hotel

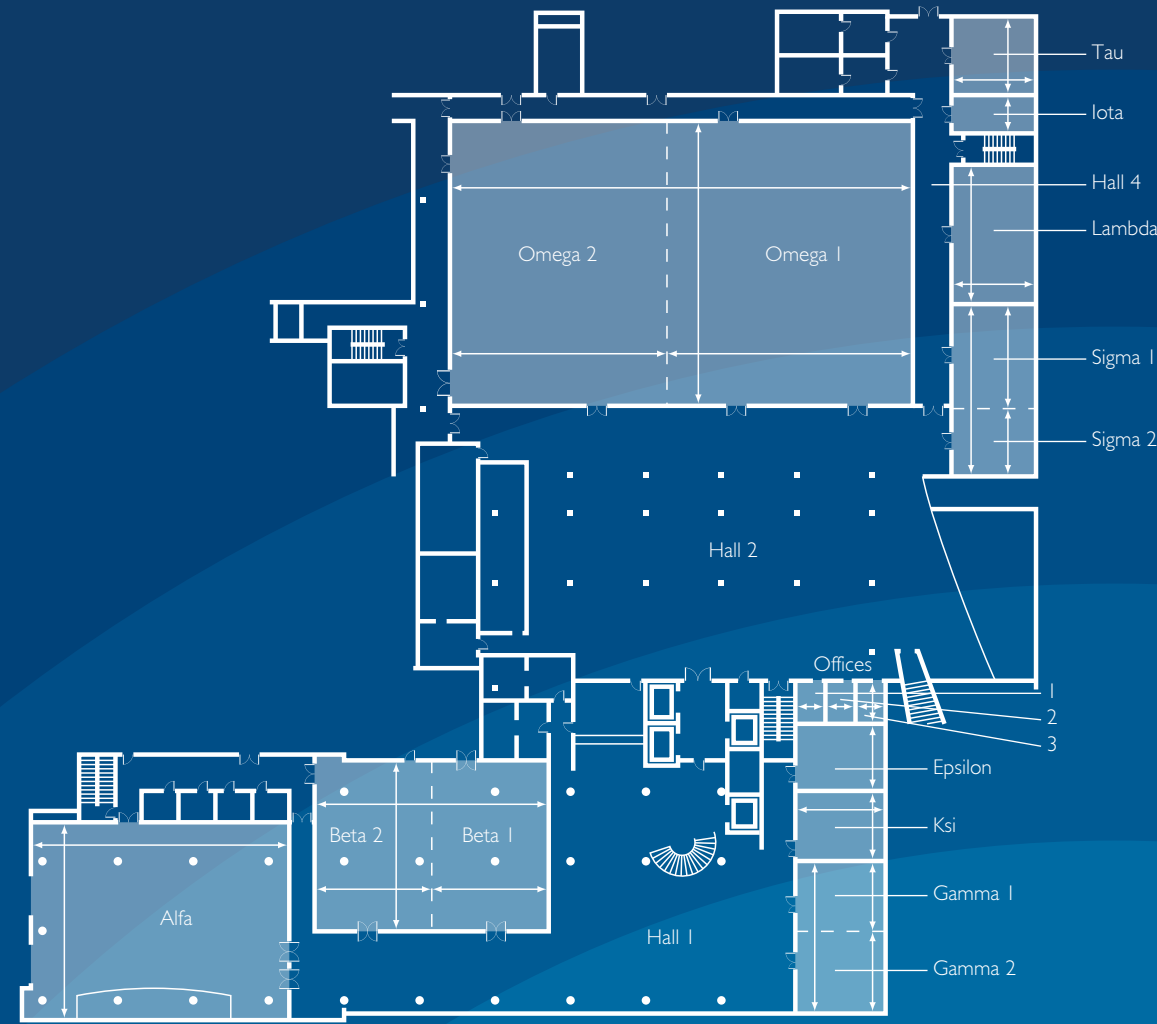

MEETING ROOM CAPACITY										
	Sq. m.	Theatre style	Classroom	Boardroom	U-shape	O-shape	Banquet	Reception	Ceiling height	Length and width
Alfa	365	400	212	-	55	72	230	350	3.18	21.85 x 16.63
Beta	288	200	120	-	-	-	120	220	2.8	19.87 x 14.2
Beta 1	142	70	50	-	20	28	60	130	2.8	9.93 x 14.20
Beta 2	146	100	60	-	34	40	70	120	2.8	10.48 x 14.20
Gamma	96	90	54	24	26	32	40	65	2.69	6.86 x 12.45
Gamma 1	44	36	22	12	16	24	12	16	2.69	6.86 x 5.86
Gamma 2	52	36	22	16	16	24	12	20	2.69	6.86 x 6.59
Ksi	40	42	24	12	16	24	12	16	3.1	5.90 x 5.60
Epsilon	44	42	24	12	16	24	12	16	2.69	5.98 x 5.85
Halle 1	605	-	-	-	-	-	-	400	3.18	-
Omega	900	1100	700	-	140	180	500	1000	4.95	39 x 24
Omega 1	505	500	300	-	74	104	250	450	4.95	20.46 x 24
Omega 2	457	500	300	-	74	104	250	450	4.95	18.54 x 24
Hall 2	797	-	-	-	-	-	-	800	2.59	-
Tau	45	42	24	12	16	24	12	20	2.4	7.05 x 6.49
Iota	22	-	-	12	-	-	-	-	2.4	7.11 x 3.10
Lambda	82	80	50	20	30	36	40	50	2.25	11.71 x 6.00
Sigma	100	90	58	24	26	32	40	65	2.3	6.93 x 14.52
Sigma 1	60	42	24	16	24	30	16	30	2.36	6.93 x 8.78
Sigma 2	40	20	16	8	14	16	8	15	2.34	6.93 x 5.64
Skyline (without Lounge) 26 <sup>th</sup> floor	316	-	-	-	-	-	-	120	-	-
Skyline (Lounge only) 26 <sup>th</sup> floor	130	-	-	-	-	-	-	40	-	-
Skyline + Lounge - 26 <sup>th</sup> floor	446	-	-	-	-	-	-	160	-	-
Skypoint - 27 <sup>th</sup> floor	67	60	40	16	26	32	48	60	2.75	6.15 x 10.90

